

Secured by Design Principles

- Visually Open
- Direct Routes
- Natural Surveillance by Dwellings
- Open-Branched/ Columnar Trees with 2m Clear Stems
- Shrub Planting of Max. 1m Mature Height
- Prevent Access by Vehicles
- Define Boundaries of Public vs Private Space

STOCKTON BOROUGH COUNCIL
PLANNING
21 DEC 2012
DATE RECEIVED



Public Open Space at Royal Quays



Example Motorcycle Barriers



Spring Flowering Bulbs



Open-Branching Trees

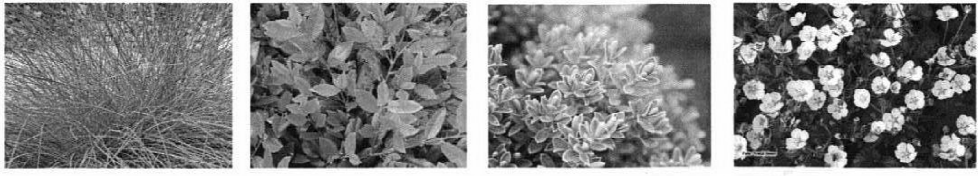

Ground Cover Shrub Planting

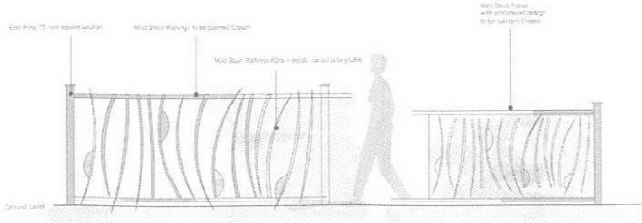
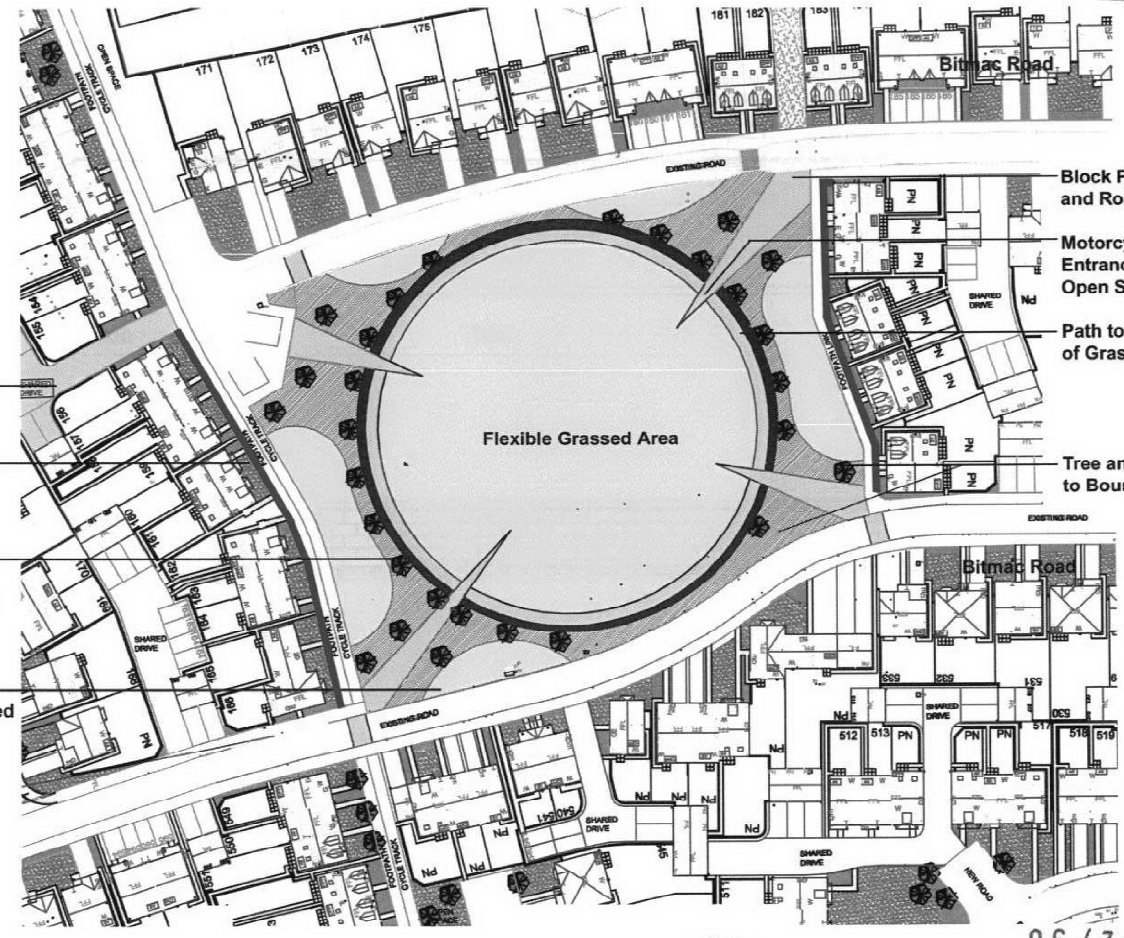

Bespoke Boundary Railings
To be used at entrances and key focal points

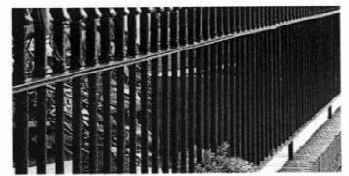

"Off the Peg" Railings to be Used as Infill - type to be agreed

Public Open Space - Hardwick, Stockton

